

# A STRONG PARTNER. FOR YOUR BOLDEST IDEAS.

ARCHITECTS, DESIGNERS AND ARTISANS APPRECIATE HI-MACS® AS A COMPETENT PARTNER CAPABLE OF TAKING ON ANY CHALLENGE. WE ARE HAPPY TO ADVISE YOU DURING THE PLANNING AND DEVELOPMENT PHASE AND ASSIST YOU IN THE SUCCESSFUL IMPLEMENTATION OF YOUR PROJECT. WE HAVE EXPERIENCED REPRESENTATIVES THROUGHOUT EUROPE WHO CAN PROVIDE YOU WITH ACTIVE SUPPORT. CONTACT US TODAY!

[www.himacs.eu](http://www.himacs.eu)

## WE WOULD BE PLEASED TO PROVIDE YOU WITH DETAILS AND INFORMATION.

HI-MACS®. The New Generation.

LG Hausys Europe GmbH  
Avenue des Morgines 12  
CH -1213 Petit-Lancy,  
Geneva - Switzerland

Tel: +41 (0)22 879 54 80  
Fax: +41 (0)22 879 54 89

[www.himacs.eu](http://www.himacs.eu)

HI-MACS® and Natural Acrylic Stone™ are registered trademarks of LG Hausys Europe GmbH. All other trademarks and product names are trademarks or registered trademarks of their respective rights owners. The information contained in this brochure is intended to be for information only and can be amended at any time without prior notification. ©2013. LG Hausys Europe GmbH. All rights reserved.



#### Publisher's Details

Fusteria Castello - Maderas y Chapas Alpisa, [www.alpisa.com](http://www.alpisa.com) | Alivar, [www.alivar.com](http://www.alivar.com) | Valter Baldan, [www.fotobaldan.it](http://www.fotobaldan.it) | Giuseppe Bavuso Studio, [www.bavuso-design.com](http://www.bavuso-design.com) | Ralf Baumgarten, [www.ralfbaumgarten.de](http://www.ralfbaumgarten.de) | Felix Bembe & Sebastian Dellinger, [www.bembe-dellinger.de](http://www.bembe-dellinger.de) | Bercei, [www.bercei.com](http://www.bercei.com) | Kovovyroba Blecha, [www.kovoblecha.sk](http://www.kovoblecha.sk) | Francesca Bottazzin, [www.francescabottazzin.com](http://www.francescabottazzin.com) | Zoey Braun Fotografie, [www.zoeybraun.de](http://www.zoeybraun.de) | Faulkner Browns, [www.faulknerbrowns.co.uk](http://www.faulknerbrowns.co.uk) | COAST Office Architecture, [www.coastoffice.de](http://www.coastoffice.de) | Delugan-Meissl Associated Architects, [www.deluganmeissl.at](http://www.deluganmeissl.at) | diephotodesigner.de, [www.diephotodesigner.de](http://www.diephotodesigner.de) | Daemyung ATM, [www.dnatm.com](http://www.dnatm.com) | Karl Dreer GmbH, [www.dreer-gmbh.de](http://www.dreer-gmbh.de) | Mathieu Ducros, [www.mathieuducros.com](http://www.mathieuducros.com) | Eift bvba, [www.eift.be](http://www.eift.be) | Flusso, [www.flusso.it](http://www.flusso.it) | Facchinetti Group, [www.facchinettigroup.it](http://www.facchinettigroup.it) | oettle ferber associates, [www.oettleferber.com](http://www.oettleferber.com) | David Franck, [www.davidfranck.de](http://www.davidfranck.de) | Focal Foto, [www.focalfoto.com](http://www.focalfoto.com) | GRAICHEN Bau- und Möbelwerkstätten GmbH, [www.graichen-gmbh.de](http://www.graichen-gmbh.de) | Zaha Hadid Architects, [www.zaha-hadid.com](http://www.zaha-hadid.com) | Joke Holvoet, [www.eift.be](http://www.eift.be) | Klopfer Surfaces, [www.kloepfer-surfaces.de](http://www.kloepfer-surfaces.de) | Mgr. Art. Kristina Krempova, [www.kristina-design.webnode.cz](http://www.kristina-design.webnode.cz) | Rafael Krötz, [www.rafaelkroetz.de](http://www.rafaelkroetz.de) | Office 53427, [www.office-kokiwoong.com](http://www.office-kokiwoong.com) | Schreineri Lell, [www.schreineri-lell.de](http://www.schreineri-lell.de) | Blaise Lambert, [www.images-aerienes.com](http://www.images-aerienes.com) | LG Collection AB, [www.lgcoll.se](http://www.lgcoll.se) | LCCA, [www.lcca.fr](http://www.lcca.fr) | ME Cubo, [www.mecubo.com](http://www.mecubo.com) | Multi-Surface Fabrications, [www.thesolidsurfacespecialists.co.uk](http://www.thesolidsurfacespecialists.co.uk) | Nordstock Oy, [www.nordstock.fi](http://www.nordstock.fi) | Simone Piva, [www.simonepiva.com](http://www.simonepiva.com) | Cadzow Pelosi, [www.cadzowpelosi.com](http://www.cadzowpelosi.com) | PurPur GmbH, [www.purpur.de](http://www.purpur.de) | RafaCub, [www.rafacub.com | Bureau Patrice Reynaud Architectes, \[www.reynaud.ch\]\(http://www.reynaud.ch\) | Thorsten Ruppert, \[www.thorstenruppert.com\]\(http://www.thorstenruppert.com\) | Realinox, S.L., \[www.realinox.com\]\(http://www.realinox.com\) | Roman Skyba, \[www.romanskybask.com\]\(http://www.romanskybask.com\) | Roskopf & Partner AG, 99996 Obermehler, Germany, \[www.roskopf-partner.com\]\(http://www.roskopf-partner.com\) | Paul Schäd Tischlerei GmbH, \[www.schad-trier.de\]\(http://www.schad-trier.de\) | RS Agencement Steiner SA, \[www.rs-steiner.ch\]\(http://www.rs-steiner.ch\) | Frederik Vercrusysse, \[www.frederikvercrusysse.be\]\(http://www.frederikvercrusysse.be\) | Dirk Wilhelmy Fotografie, \[www.dirkwilhelmy.com\]\(http://www.dirkwilhelmy.com\) | Tischlerei Woodstar, \[www.tischlerei-woodstar.de\]\(http://www.tischlerei-woodstar.de\)](http://www.rafacub.com)



THE NEW GENERATION.  
Inspired by Architecture.

**HI-MACS®**  
Natural Acrylic Stone™





WE LOVE ARCHITECTURE.  
BECAUSE IT'S THE STAGE  
FOR OUR LIVES.  
BECAUSE IT GIVES US  
FRESH INSPIRATION  
EACH DAY TO REINVENT  
OUR SPACES.

HI-MACS® is growing into the material of choice for high-end interior design. Linear designs with precise edges, elegant curving forms and emotional lighting effects: almost anything is within reach for this material of possibilities.

Project: Private House, Italy - Design: Simone Piva -  
Fabrication: Simone Piva - Photo: Francesca Bottazzin

To make sure it stays that way, we have developed a solid surface that gives architects, designers and craftsmen the ultimate creative freedom: HI-MACS®. The material of the “New Generation”. For your ideas, dreams and spaces.



# FEEL COMFORTABLE WHEN IN YOUR STYLISH HOME

From the kitchen and bath to complete interior designs, from wide-open sleeping spaces to perfect solutions for the smallest details - HI-MACS® does much more than you might think, thanks to its excellent material properties, highly advanced manufacturing process and creative flexibility. The material adapts to your every vision, plan and requirement to meet each challenge head on - both today and tomorrow. This is what makes HI-MACS® the material of the future, and the material of the “New Generation”.



**A major plus in comfort**  
The pleasant, velvety look of this material makes it perfect for your intimate spaces, the bath and bedroom.

The complete frame for the ethanol fireplace is easy to maintain and implemented in white HI-MACS® without visible joints.



The spacious working surface transitions fluidly from the kitchen into the eating area.

**Robust elegance**  
Extremely lovely in living spaces, extremely durable in the kitchen. HI-MACS® mediates all desires perfectly, without making compromises.

# OUTSTANDING FEATURES ABOUND. A COMPELLING MATERIAL.

HI-MACS® is an intelligent composition of acrylic, natural minerals and pigments that come together to provide a smooth, non porous and visually seamless surface which meets the highest standards for aesthetics, functionality and hygiene. Thanks in large part to its flexibility, HI-MACS® offers manifold advantages over conventional materials.



## Seamless perfection

HI-MACS® allows for visually seamless manipulation. Smooth integration enables large areas without joints or edges as well as flush mounting of sinks or bowls. Not only do objects made from this solid surface material appear to be works of art cast from a single mould, the material's seamless manipulation and non porous nature create surfaces which are extremely hygienic, easy-to-clean and thus ideally suited for use in hospitals and laboratories. The seamless finish also allows for repair and replacement without a visible trace should any part of a HI-MACS® installation be damaged at any time.

## Unlimited colour spectrum

Along with choice of material, colour selection is a crucial factor when it comes to high-quality design. Elegant White, warm Toffee Brown, bold Florida Orange, mystical Cima, translucent pastels or fine shimmer textures. HI-MACS® offers a virtually limitless range of colours in all conceivable shades. More are being added every year, no matter what colour you choose, HI-MACS® remains 100% homogeneous.

## Three-dimensional design

HI-MACS® boasts a simple heating process and three-dimensional thermoplastic forming capabilities. This allows for greater forming flexibility compared with other conventional materials so that spectacular ideas can quickly take on a concrete shape. No radius, shape or angle is impossible. The logical conclusion: a material that moulds to your idea and designs - not the other way around. Exactly how it should be.

## Dramatic translucency

Certain colours and thicknesses of HI-MACS® exhibit a special translucency when exposed to light. Various textures and patterns can be built into the material to intensify the HI-MACS® translucency effect. Depending on the light source, pattern and design, spectacular cut-out effects can add visual interest and create a completely new sense of space. The translucent properties of this solid surface material make it the perfect choice for lamps and illuminated furnishings.

## Simple processing

Although HI-MACS® is almost as robust as stone, it can be worked in the same way as wood. Using conventional carpenters' tools, this solid surface material can be sawn, routed or drilled. It lends itself to the creation of an endless variety of multi-dimensional forms and much, much more. No wonder most people working with the material have a background in woodworking and appreciate HI-MACS® as a natural partner for innovative ideas.



# SHAPING THE FUTURE. IN HARMONY WITH THE ENVIRONMENT.

Countless internationally recognized certificates attest to the fact that HI-MACS® is a completely eco-friendly material. Without exception, all HI-MACS® products are manufactured in accordance with the ISO 14001 environmental standard.

— **Composition:** aluminium trihydroxide, the main component of HI-MACS®, is a bi-product of aluminium production.  
— **Manufacturing:** The production of this material is marked by an excellent energy balance. In addition, HI-MACS® plants in Cheongju (Korea) and Atlanta (USA) meet all environmental standards.  
— **Transport:** The material is transported from the USA to Europe exclusively by ship. Within Europe, HI-MACS® observes the Euro-5 standards for reduced particulate emissions. The engines in HI-MACS® transport vehicles switch off automatically when the vehicle has been stationary for more than five minutes.

— **Processing:** The material allows for virtually waste-free processing.  
— **Disposal:** HI-MACS® can be disposed of with household waste and burned without emitting toxic fumes.  
— **Commitment:** LG Hausys conducts and publishes regular environmental audits along with energy consumption analyses. Thanks to the use of non-polluting fuels, greenhouse gas emissions have been cut by 15,000 tons per year since 2008.



## The Eden collection. Eco-friendly through and through.

The Eden colour collection by LG Hausys is the most environmentally friendly solid surface material available on the market today. This one-of-a-kind colour palette consists of up to 41% recycled materials and is available in 8 warm, natural shades.  
  
The Eden collection has been recognized by the U.S. Scientific Certification System for the large proportion of recycled material it uses. Furthermore, projects made from HI-MACS® Eden are eligible for LEED (Leadership in Energy and Environmental Design) certification from the U.S. Green Building Council, and may receive up to 2 credits in various LEED categories. Another solid and sustainable reason to choose HI-MACS®.





# ADVANCED TECHNOLOGY. FOR THE NEW GENERATION.

HI-MACS® is manufactured using a modern production method which includes strict safety standards and the regular inspection of raw materials. A new generation technology, the thermal cure, brings the material to a high temperature. The temperature reached during the manufacturing process sets HI-MACS® apart from other solid surface materials and creates a denser, even more homogeneous, sturdy and durable surface - with a better heat resistance and superior thermoforming qualities. Proving once again that HI-MACS® lives up to its reputation as the material of the "New Generation".



## COMMITTED TO QUALITY.

The HI-MACS® Quality Club is made up of experienced fabricators, processing plants and installation engineers. All members receive a top-quality individual training at an authorized Training Centre. All with the goal of ensuring that objects made from this solid surface material are created and processed under the highest quality conditions.

Loyalty is rewarded in the long-term with a 15-year warranty for products fabricated and installed by a member of the HI-MACS® Quality Club. End users also benefit from an extremely high standard for service quality, and can rest assured in the durability of their HI-MACS® product.



# HI-MACS® IS A TRUE ALL-AROUND TALENT IN A NUMBER OF MARKET SEGMENTS.

- LIVING SPACES
- KITCHEN
- BATH
- HOTELS
- FACADES AND WALL CLADDING
- PUBLIC BUILDINGS
- SHOPS AND EXHIBITIONS
- GASTRONOMY
- AIRPORTS
- MARINE INDUSTRY
- EDUCATIONAL INSTITUTIONS
- HEALTHCARE
- FURNITURE DESIGN



Project: Hotel Silken Puerta America, Spain - Design: Zaha Hadid Architects - Fabrication: Roskopf & Partner AG - Photo: diephotodesigner.de

## Hotels

HI-MACS® is an excellent choice for hotels thanks to its class and elegance. It boasts an exceptional value for money, a long lifespan and a vast array of creative possibilities. So it's only logical that HI-MACS® is a trusted material in numerous examples of today's most sought-after hotels.





**An entire house made of HI-MACS®**  
Whether the emphasis is on individual elements, as is the case here, or a more seamless look - HI-MACS® lets you build complete and perfect high-functional facades.

Project: Korean Pan-gyo House, South Korea - Design: Office 53427 - Fabrication: Daemyung ATM - Photo: Yongkwan Kim

## Facades and wall cladding

HI-MACS® looks good inside and out. It is ideal for use in facades because of its weather- and UV resistant properties. Among the 12 selected colours

for outdoor applications, the tones are guaranteed 5 years for a tolerance of Delta E3 to Delta E4 according to the colour.

## Public buildings

HI-MACS® gives a significant boost to both design-related and functional possibilities. All kinds of ideas can be implemented with it, and even the most specific of requirements fulfilled. Opting for HI-MACS® is a safe

decision in the long term as well: the material undergoes all relevant product testing, meets the German Class B1 criteria for fire protection and boasts countless certificates which attests to its exceptional quality.



Milled inlays are set off to the best effect by dramatic backlighting.

An elegant HI-MACS® reception desk plays up the luxurious minimalist ambience.

Project: Porsche Museum, Germany - Design: Delugan-Meissl ZT GmbH - Fabrication: GRAICHEN Bau- und Möbelwerkstätten - Klöpfer Surfaces - Photo: Zoey Braun Fotografie



Illuminated displays show off antique paintings and HI-MACS® sheen.

Project: Schiller Museum, Germany - Design: COAST Office Architecture - Fabrication: Schreinerei Leil - Klöpfer Surfaces - Photo: David Franck





The pivotal point of the showroom: intricate circular latticework made from HI-MACS®.

All eyes over here: a streamlined display area deliberately directs the viewer's eye.

Project: Showroom ALV, Italy - Fabrication: Flusso, Facchinetti Group - Photo: Valter Baldan Fotografo

## Shops and exhibitions

All high-traffic, high-strain areas require a highly functional, durable material. Stores and exhibition spaces are no exception. Fortunately, HI-MACS® has no trouble meeting all these criteria.



Project: Audi international Stand - Design: oettle ferber associates - Photo: Zoëy Braun Fotografie

## Gastronomy

Whether playful and romantic, super hip or classic cosmopolitan, HI-MACS® lets architects and designers create the mood of their choice. The properties of this solid surface material are as varied as the wishes of restaurant owners and their guests.



Project: Bar Counter, Slovakia - Design: Mgr. Art. Kristína Krempová - Fabrication: Kovovýroba Blecha - Photo: Roman Skyba



Stable substructure and illuminated design highlights all in one.

Gorgeous! This bar is magnificently stylish and functional. Water and a moist cloth are all that's needed to take care of HI-MACS® for years to come.

Project: Bar im Main Palais, Germany - Design: PurPur GmbH - Fabrication: Paul Schad Tischlerei GmbH - Klöpfer Surfaces - Photo: Thorsten Ruppert





## Living spaces

From floors to walls, from the terrace to the mantelpiece: HI-MACS® turns living spaces into customized live-in landscapes that appear to come from a single cast.



The HI-MACS® fireplace: elegance and exceptional heat resistance in one.



An imaginative table that reaches towards the pool like a diving board, now a reality thanks to this flexible material.

Project: Private House, Germany - Design: Karl Dreer, Felix Bembé & Sebastian Dellinger - Fabrication: Innenausbau Dreer GmbH - Klöpfer Surfaces - Photo: Dirk Wilhelmy Fotografie



The key ingredient: the right material. HI-MACS® is virtually everywhere in this kitchen. Its countertops, sink, drawers and appliance casings are made from the solid surface material.

Sinks are flush with the countertop.

## Kitchen

HI-MACS® features a smooth, non porous and stain-resistant surface which is easy to clean and thus ideally suited for working with food. All installations created using this material are resistant to household chemicals. HI-MACS® also offers a wide range of matching sinks and makes it easy to create custom-made installations.

Project: Private House, Sweden - Fabrication: LG Collection - Photo: Focal Foto

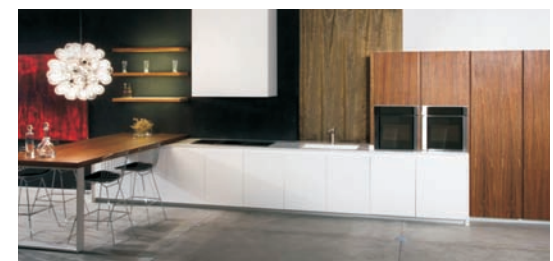

Project: Bercei Kitchen, Spain - Fabrication: Realinox - Design: Mauel Menendez for Bercei



Bath

Thanks to its unique look, water-resistant surface, and pleasant feel, HI-MACS® is ideally suited for use in the bathroom. HI-MACS® is an extremely sanitary, easy-to-clean material with a large selection of wash basins to explore.



**The perfect material for any bathroom**  
A square sink, fitted seamlessly into the counter, with stylish, flush furniture facings, a low-maintenance wall and tub cladding – all from one material: HI-MACS®

Project: Taskirdi, Belgium – Design: Joke Holvoet for Eift bvba – Fabrication: Eift bvba – Photo: Frederik Vercruysse



The accentuating elements in this check-in hall are the funnel-shaped pillars that widen toward the ceiling: elegant and seamlessly uniform.

Project: Column cladding at Airport Paris Charles de Gaulle, France – Design: Marc Fidelle and Andrei David, Direction de l'Ingénierie et de l'Architecture d'Aéroports de Paris – Fabrication: LCCA – Photo: Mathieu Ducros

Airports

Counters, shelves and other surfaces at airports are exposed to heavy loads and constant touching. This is why they must be manufactured from an extremely durable material which is both easy to clean and smooth and pleasant to the touch. HI-MACS® fits the bill: with this high-quality mineral material, installations will look as good as new for years to come.



Project: Sustento New, Belgium – Fabrication: Eift bvba – Interieurinrichting

Marine industry

HI-MACS® is enjoying more and more popularity in the shipbuilding industry. On the one hand because the material is ideal for high-demand installations; on the other hand, because it meets essential criteria such as those for fire resistance and low flame propagation. A special formula of HI-MACS®, HI-MACS® FR, has been recognized for its excellence in this area with a Module B and D IMO certificate from the Marine Equipment Directive.



Educational institutions

HI-MACS® is a favorite in universities and schools because of its visually seamless finish and non porous, sanitary surface. An independent laboratory has confirmed that the material's hygienic properties comply with international LGA and NSF standards.



Healthcare

HI-MACS® is the material of choice in hospitals and laboratories thanks to its internationally certified resistance to dirt, viruses, bacteria and many chemicals. In addition to these sanitary advantages, the material boasts a number of other benefits including extreme durability and excellent value for money.



**The perfect material for using horizontally or vertically**  
A Sink and counter in white with furniture facings in an elegant anthracite: all effortless to keep hygienic and clean.

Project: Aesthetic medical centre Imaderm - Design: Patrice Reynaud Architectes - Fabrication: RS Agencement Steiner SA, kläusler acrylstein ag - Photo: Blaise Lambert



**Hygienic and lovely in shape**  
Perfect hygiene is a decisive factor when working in the medical field. When 3D formation is skilfully applied and mixed with emotional lighting, even a physician's practice can be turned into an impressive experiential space like this one.



## Furniture design

Both classic and contemporary design ideas can be implemented thanks to the extensive colour palette, translucency and virtually limitless design flexibility of “Natural Acrylic Stone”. The end results are creations that would be impossible to achieve with conventional materials.



Nothing is impossible with HI-MACS®:  
A bookcase with unconventional geometric  
elements stacked on top of one another  
to form a honeycomb.

## THE MAIN ADVANTAGES. AT A GLANCE.

The following properties make HI-MACS® stand out as the material of the “New Generation”:

- Virtually unlimited range of applications
- Countless possibilities for customized design (colour, formability, translucency, etc.)
- Valuable, laboratory-tested raw materials
- Advanced manufacturing techniques
- High-quality processing technology
- Ecological commitment
- Wide range of sinks and bowls
- Ease of maintenance thanks to dirt-repellent surfaces
- Resistance to common household chemicals
- Resistance to bacteria and viruses
- Fire resistance and low flame propagation properties
- Excellent value for money
- 15-year warranty, which is the only one of its kind on the market



# SINKS & BOWLS

Every option is available to designers to create neat washrooms, kitchens, hospitals and much more with our wide range of HI-MACS® sinks and bowls. Perfectly coordinated and ideal for mixing and matching, the bowls and sinks guarantee a modern look that is easy and simple to look after.

## HI-MACS® Bowls

HI-MACS® bowls offer superb ease of cleaning and a warm and pleasant feel, making them the ideal solution for creating the bathroom of your dreams. They are manufactured using a casting process and ideally suited for both flush mounting and installation into a bathroom vanity top.

## HI-MACS® Baby Bath

Nothing less than the maximum level of hygiene, ergonomics and warmth is good enough for the neonatal ward of any hospital. With ultra-soft corners and contours ergonomically designed specifically for babies, the new HI-MACS® Baby Bath is the perfect product for babies’ first baths of their lives.

HI-MACS® sinks and HI-MACS® washstands are available in Alpine White S28 and Nougat Cream S201. HI-MACS® Baby Bath is available only in Alpine White S28. Warranty: 15 years on all precast HI-MACS® bowls, sinks and baby bath.

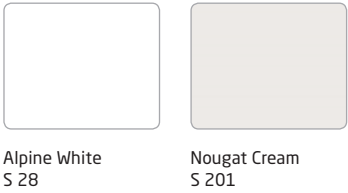
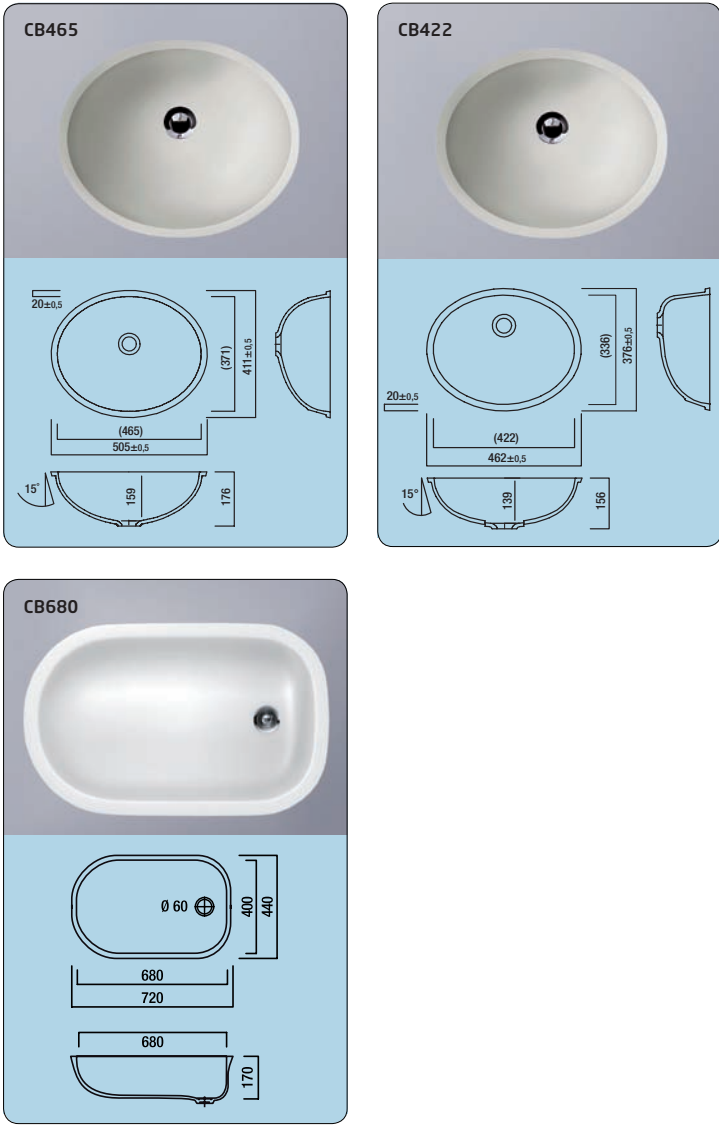

Only by special order:  
S01, S02, S03, S04, S05, S06,  
S09, S29, S204, S214

## HI-MACS® Sinks

HI-MACS® sinks are produced using a high-quality casting technique. No matter which product you choose from our extensive, eminently combinable selection, all sinks are flush-mounted into the countertop or installed below the surface. Special custom-made creations are also an option.

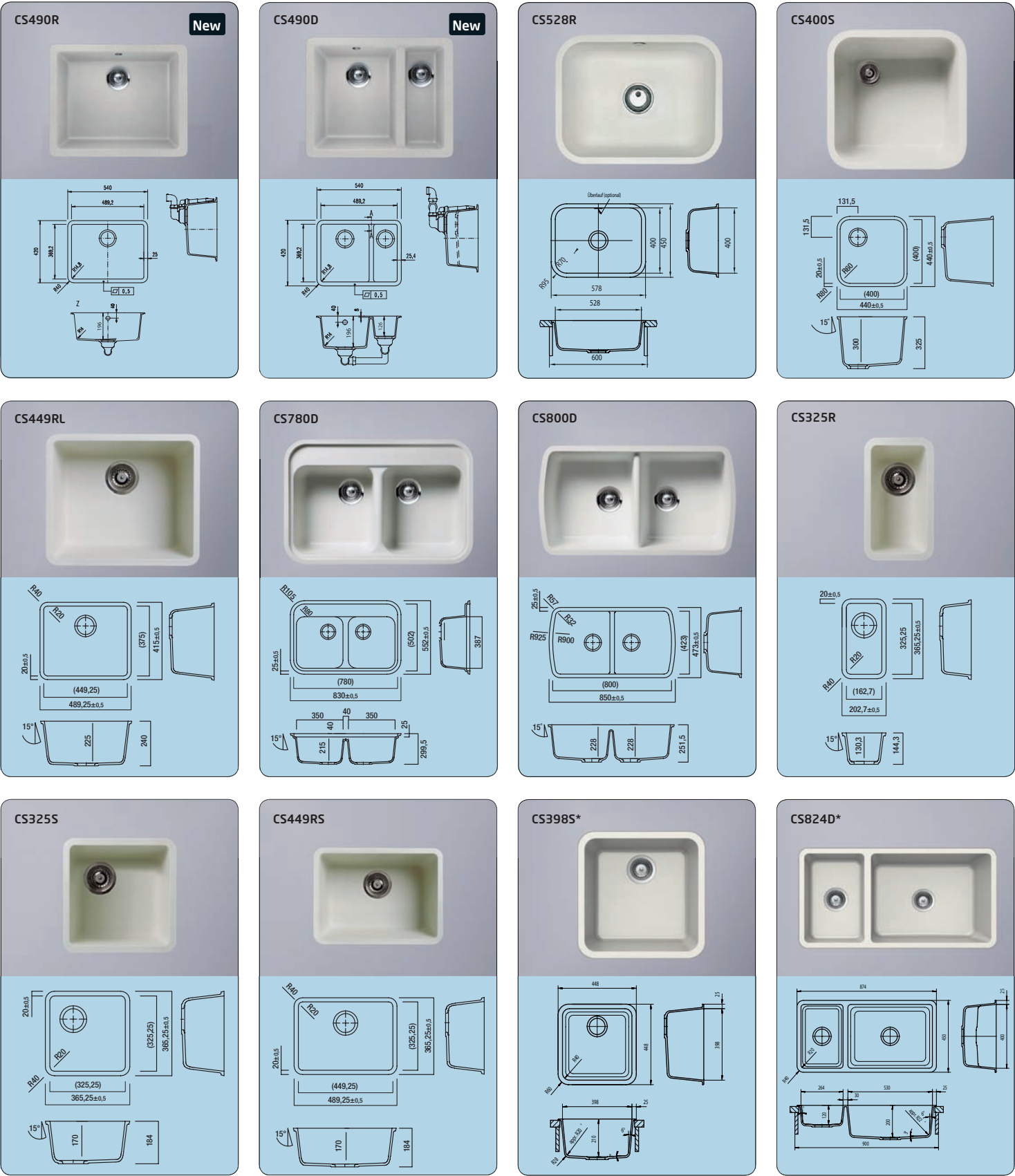



Dimensions - Sheet material

Standard Format      \* Only available in S28 Alpine White.

Sheet thickness in mm	Sheet width in mm	Sheet length in mm
3*	930	3000
6	760	2490
9	760	3680
12	760	3680

Special Format

Sheet thickness in mm	Sheet width in mm	Sheet length in mm
6	910	2490
9	910	3680
12	910	3680

Chemical resistance

HI-MACS® is a fully homogenous material with no pores and is thus simple and easy to clean.

Test substance	Application time	Evaluation of G02 changes	Evaluation of S06 changes
Acetic acid	16h	no change	no change
Citric acid	16h	no change	no change
Sodium carbonate	16h	no change	no change
Ammonium hydroxide	16h	no change	no change
Ethyl alcohol	16h	no change	no change
White wine, red wine	16h	no change	no change
Beer	16h	not tested	not tested
Cola drinks	16h	no change	no change
Instant coffee	16h	no change	no change
Black Tea	16h	no change	no change
Blackcurrant juice	16h	no change	no change
Cream	16h	no change	no change
Water	16h	no change	no change
Petrol	16h	no change	no change
Acetone	16h	3	3
Ethyl butyl acetate	16h	3	3
Butter	16h	no change	no change
Olive Oil	16h	no change	no change
Mustard	16h	no change	no change
Salt	16h	no change	no change
Onions	16h	no change	no change
Lipstick	16h	no change	no change
Disinfectant	16h	no change	no change
Black pen - ballpoint	16h	2	2 - 3
Stamping ink	16h	1	1
Cleaning agent	16h	no change	no change
Cleaning solution	16h	no change	no change
Wear resistance group according to DIN 68861*	16h	1B	1B
Evaluation according to DIN 68930 Table 1 Other work surfaces: wear resistance group: «1C»		Requirement met +	according to DIN 68861 & DIN 68930

HI-MACS® can be supplied in different sheet thicknesses, formats and sizes. Ideal for maximum cutting, minimum wastage and minimal costs. However, not all colours are available in any thickness. Please see the colour charts on the following pages for exact availability.

HI-MACS® FR-version sheets are available in S 28 Alpine White and manufactured to order in S201 Nougat Cream, S29 Ivory White, S06 Arctic White and S05 Grey. They have greater fire resistance and comply with the IMO Standard Modules B+D and M1. FR sheets are especially suitable for use in public buildings and as wallpanels.

Technical data sheet

HI-MACS® is extremely repellent to dirt and exceptionally wear and tear, so that you can enjoy many years of pleasure with the outstanding quality of your new product.

Specification	Unit	Result		Test methods
		Solids	Granite	
Flexural-E-modulus	MPa	8900	7730	DIN EN ISO 178
Flexural strength	MPa	70.1	64.3	ASTM D638
Breaking elongation	%	1	1.1	DIN EN ISO 178
Tensile strength	MPa	69.5	56.3	DIN EN ISO 527
Density	g/cm³ kg/cm³	1.75 1750	1.65 1650	ISO 1183 ISO 1183
Ball indentation hardness	N/mm²	257	239	DIN EN ISO 2039-1
Mohs hardness		2 bis 3	2 bis 3	EN 101
Pencil hardness		>9H	>9H	ISO 15184
Water absorption weight strength/thickness		<0,1 % <0,1 %	<0,1 % <0,1 %	DIN EN 438 Part 12
Impact resistance impactor drop ball test (fall height)	N mm	≥25 ≥1500	≥25 ≥1500	Ε DIN EN 438, 02/02 Part 2/20 Ε DIN EN 438, 02/02 Part 2/21
Slip resistance		>0,32 - 0,9		GMG100 (replaces R9)
Slip resistance		angle of acceptance of more than 10° to 19° = R10		DIN 51130
Climate change resistance	°C	≥0,05	≥0,05	AMK
Dry heat (pan base)	°C	≥100 (7C)		DIN 68 861, Part 7, 04-'85
Damp heat (pan base)	°C	≥100 (7C)		DIN 68 861, Part 8, 04-'85
Temperature change resistance	°C	no change		UNI 9429
Resistance to cigarette burns		6C	6B	DIN 68 861, Part 6, 11-'82
Scratch resistance		4D	4B	DIN 68 861, Part 4, 11-'81
Electrostatics Conductivity	>1x110 <sup>12</sup> Ω	insulating non-conductive		DIN IEC 1340-4-1, 04-'92 EN 61340-5-1
Thermal conductivity	W/mK	0.636	0.55	DIN EN 12664
Thermal resistance	m²K/W	0.038	0.045	DIN EN 12664
Thermal expansion co-efficient	mm/mK m/m/°C	0.048 30.0 x 10 <sup>-6</sup>	0.055	DIN EN 14581
Water vapour permeability				
Diffusion resistance factor	μ	18607	16150	
Dimensional change by change in relative humidity length thickness mass	% % %	-0.03 0.06 0.05	-0.02 0.03 0.05	
Resistance to boiling water increase in weight increase in thickness	% %	<0,1 <0,1	>0,1 <0,1	Ε DIN EN 438, 02/02 Part 2/12
Light fastness (Xenon)	scale 0 - 10	better than 6	better than 6	DIN 53 387, 04-'89
Food tolerance		suitable for all colours		LMBG § 31
Hygiene		suitable	suitable	LGA Hygiene Certificate
Fire protection classification Flame-retardant properties MPA/NRW HI-MACS® MPA/NRW (BAM) 12 mm (BAM) 9 mm + back-up (Bodycote/Warrington) 12 mm		B1 non-dripping material B1 for all colours* B1 for all colours* B-s1 , d0 for all HI-MACS® colours* complies with BS 476 class 0		DIN 4102-1 DIN 5510  DIN 4102-1 BS EN ISO 11925-2 : 2002 BS EN 13823: 2002
* (not currently applicable to Marmo)				



COLOURS

Colours are key in design. Elegant Nordic White, warm Toffee Brown or mystical Cima.

We have whatever colour you want - it's your choice.

Lucent

When combined with precisely positioned light sources, the translucent pastel shades become transformed into dramatic design “highlights”.

Opal  
S302 [12/9/6 mm], ΔE4

Sapphire  
S303 [12 mm]

Ruby  
S304 [12 mm]

Emerald  
S305 [12 mm]

Solids

From elegant to extravagant, classic to ultra-contemporary - this is a limitless collection.

Nordic White  
S033 [12 mm]

Alpine White  
S28 [12/9/6/3 mm], ΔE3

Diamond White  
S034 [12 mm]

Arctic White  
S06 [12/9/6 mm]

Ivory White  
S29 [12/9/6 mm]

Satin White  
S01 [12/9/6 mm]

Cream  
S09 [12/9/6 mm], ΔE3

Nougat Cream  
S201 [12 mm]

Almond  
S02 [12/9 mm], ΔE3

Babylon Beige  
S102 [12/9 mm]

Concrete Grey \*  
S103 [12/9 mm]

Carmenere \*  
S110 [12 mm]

Jasmine Green \*  
S101 [12/9 mm]

Toffee Brown \*  
S104 [12/9 mm]

Marta Grey \*  
S108 [12 mm]

Mill Olive \*  
S114 [12 mm]

Light Green \*  
S212 [12 mm]

Lemon Squash \*  
S106 [12 mm]

Banana \*  
S26 [12 mm]

Orange \*  
S27 [12 mm]

Florida Orange \*  
S105 [12 mm]

Fiery Red \*  
S25 [12 mm]

Festival Pink \*  
S116 [12 mm]

Chiffon  
S113 [12 mm]

Steel Grey \*  
S109 [12 mm]

Grey  
S05 [12/9/6 mm]

Midnight Grey \*  
S117 [12 mm]

Greenish Gray \*  
S112 [12 mm]

Sky Blue  
S203 [12 mm]

Mazarin Blue \*  
S107 [12 mm]

Deep Indigo \*  
S115 [12 mm]

Dark Night \*  
S111 [12 mm]

Coffee Brown \*  
S100 [12 mm]

Black \*  
S22 [12/9 mm]



Eden

A one-of-a-kind palette with warm natural shades and various grain sizes. What makes the collection unique: it consists of up to 41% recycled materials.

Cocoa  
G501R [12 mm]  
12% Recycled Content

Sugar Maple  
G510R [12 mm]  
40% Recycled Content

Poplar  
G511R [12 mm]  
40% Recycled Content

Birch Bark  
G514R [12 mm]  
40% Recycled Content

Pecan  
G515R [12 mm]  
41% Recycled Content

Hickory  
G516R [12 mm]  
40% Recycled Content

Mountain Ash  
G517R [12 mm]  
40% Recycled Content

Ripe Cotton  
G518R [12 mm]  
12% Recycled Content

The Eden collection is available upon special request. More information about this range and its environmental benefits can be found on pages 8 and 9 of this brochure.

Scoring eco-credits across the board.

The LEED (Leadership in Energy and Environmental Design) seal is a proven classification system for ecological, resource-saving and sustainable construction. The credit-based certification process rates buildings on a number of different criteria. Opting for HI-MACS® Eden in new construction and renovation projects may provide up to 2 credits in the following LEED categories:

Indoor Environmental Quality (IEQ)  
LEED IEQ 4.1: low-emission materials, adhesives and sealants (1 credit)

Materials & Resources (MR)  
LEED MR 4.1: materials with more than 10% recycled content (1 credit)  
LEED MR 4.2: materials with more than 20% recycled content (2 credits)

Galaxy

With transparent grains and mother of pearl shimmer, as if from another world.

Uranus  
T02 [12 mm]

Nebula  
T10 [12 mm]

Venus  
T11 [12 mm]

Mars  
T16 [12 mm]

Andromeda  
T17 [12 mm]

Carina  
T18 [12 mm]

New Moon  
T19 [12 mm]

Hercules \*  
T20 [12 mm]

Marmo

You will be captivated by its sophisticated texture, reminiscent of marble.

Bologna  
M103 [12 mm]

Roma \*  
M104 [12 mm]

Verona \*  
M105 [12 mm]

Volcanics

Full of depth and mysticism, akin to a precious natural stone but with all of the advantages of “Natural Acrylic Stone”.

Gemini  
VW01 [12 mm]

Tambora  
VE01 [12 mm]

Mayon  
VE23 [12 mm]

Santa Ana  
VA01 [12 mm]

Frosty  
VA22 [12 mm]

Maui  
VG21 [12 mm]

Taos \*  
VB21 [12 mm]

Cima \*  
VB02 [12 mm]

Granite, Quartz, Sand & Pearl

A huge selection of textures and colours. Natural, elegant and perfect to combine.

Arctic Granite  
G34 [12/9/6 mm], ΔE3

White Granite  
G05 [12/9 mm], ΔE4

Natural Granite  
G23 [12/9 mm]

Grey Granite  
G17 [12/6 mm]

Greystone Granite  
G60 [12 mm]

Platinum Granite  
G07 [12 mm]

Grey Crystal  
G102 [12 mm]

Peanut Butter  
G100 [12 mm]

Mocha Granite  
G74 [12 mm]

Celebration Granite \*  
G40 [12 mm]

Black Granite \*  
G31 [12/9 mm]

White Quartz  
G04 [12/9/6 mm], ΔE4

Crystal Beige  
G101 [12 mm]

Moonscape Quartz  
G58 [12/9 mm]

Confetti Quartz  
G41 [12/9 mm], ΔE4

Sea Oat Quartz  
G38 [12/9 mm], ΔE3

Ivory Quartz  
G30 [12/9 mm], ΔE4

Rose Quartz  
G06 [12 mm]

Allspice Quartz  
G63 [12/9 mm]

Lunar Sand  
G108 [12/9 mm]

Pebble Pearl  
G107 [12/9 mm]

Riviera Sand  
G106 [12/9 mm]

Beach Sand  
G48 [12/9 mm], ΔE3

Almond Pearl  
G08 [12/9/6 mm]

Desert Sand  
G01 [12/9 mm]

Tapioca Pearl  
G50 [12/9 mm]

Grey Sand  
G02 [12/9/6 mm], ΔE4

Venetian Sand  
G42 [12 mm]

Brown Pearl \*  
G105 [12 mm]

Oregano Sand  
G62 [12 mm]

Midnight Pearl \*  
G15 [12/9 mm]

Black Pearl \*  
G10 [12/9/6 mm]

Black Sand  
G09 [12/9/6 mm]

The basic HI-MACS® material is identical for every colour, although darker hues have a higher percentage of natural pigments, which need more careful care and attention. Colours indicated with a \* are more suitable for surfaces which are subject to less wear and tear and are therefore used more often for contrasts or inlay work. There may be some slight variation in colour between the illustrated and actual colours due to printing techniques.

12 HI-MACS® colours are particularly suitable for outdoor applications because of their good UV-resistance. Their colour-fastnesses are guaranteed 5 years for a tolerance of Delta E3 (indicated with Δ E3) to Delta E4 (indicated with Δ E4) according to the colour.